



Greyfriars Square Play and Fitness

Initial testing and spatial requirements

REV A

LD&DESIGN

SUMMARY

The following slides explore, should proprietary play or fitness equipment be seen by The City of London as a requirement, the location these types of features could go, and, how much space they absorb:

1. We show ‘areas of exclusion for play and fitness’ and provide a rationale as to why equipment of this nature should not be included within specific parts of the design. And, if we were to include, why we have shown the location we have. This covers aspects such as:

- movement,
- views,
- set back from vehicular space and HVM alignment,
- setting of special features,
- role and identity of previously agreed concept.

2. We then illustrate the typical space required for a selection of proprietary formalised play and sport/fitness equipment.

N.B. the equipment shown is not intended to illustrate options or potentially chosen equipment but only instead shows what trade-offs might need to be considered.

All equipment has safety and fall zones associated, this results in a significant loss of either green space or green space and footway/circulation space. Further to this, smaller slithers of planting that remain may be considered a maintenance challenge so further reduction from the figures shown may be an outcome, further consideration required following decision.

STAGE 2 PLAY OUTLINE CONCEPT



Through Stage 2 an opportunity was identified to re-use 58no. remarkable granite blocks (currently in use as part of the Thames to Eternity Project) as an elegant special play feature, aligned with the key axis to St Pauls. At conceptual stage it was agreed the Alee Bridge Walk formed the appropriate play function for Greyfriars Square.

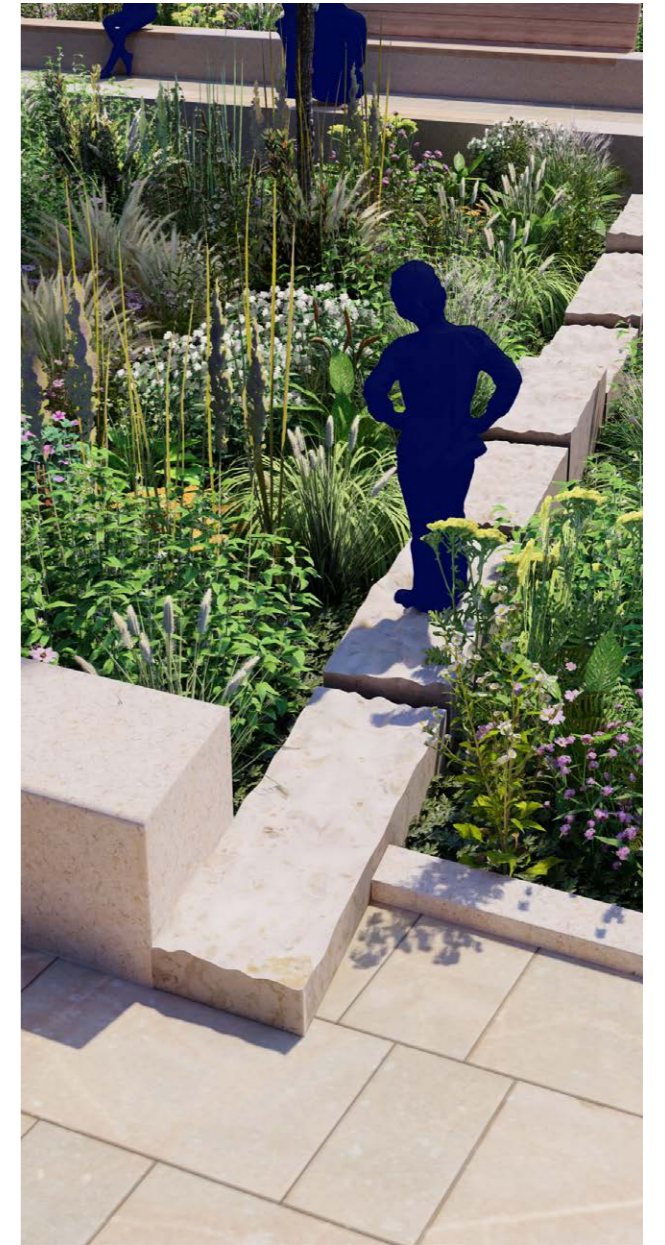
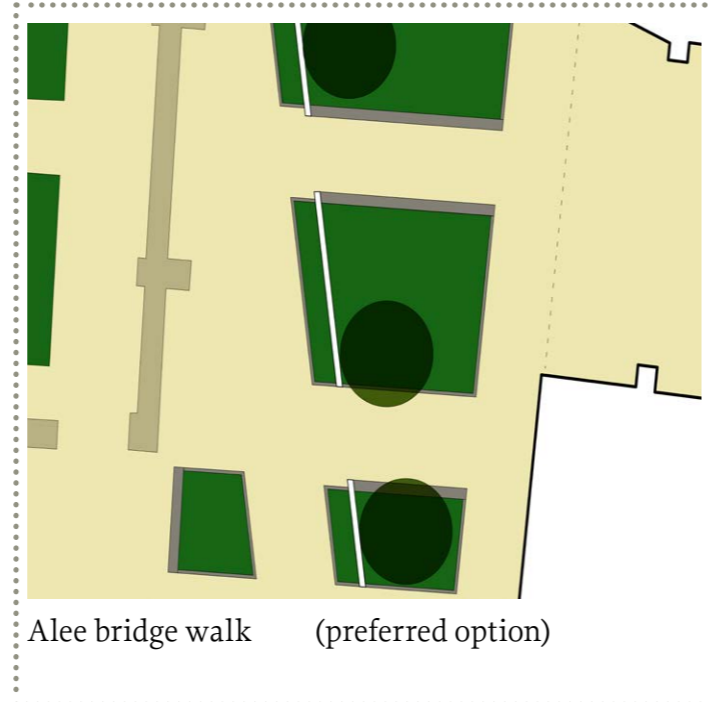

**AREAS OF EXCLUSION FOR PLAY AND/OR
FITNESS EQUIPMENT**

Axial Route

The axial route through the space critically sets up the principal structure for the proposal. The grand processional route is intentionally wide (4m) and clear to allow sufficient space for pedestrian movement (both fast and slow), allowing for people to pause and enjoy the surroundings or stand and watch children play on the Alee Bridge Walk.



**AREAS OF EXCLUSION FOR PLAY AND/OR
FITNESS EQUIPMENT**

Key movement routes

The proposal seeks to make Greyfriars square an easy and well connected place to move through. Principal movement routes should be protected and remain uncluttered to ensure circulation is well provided.

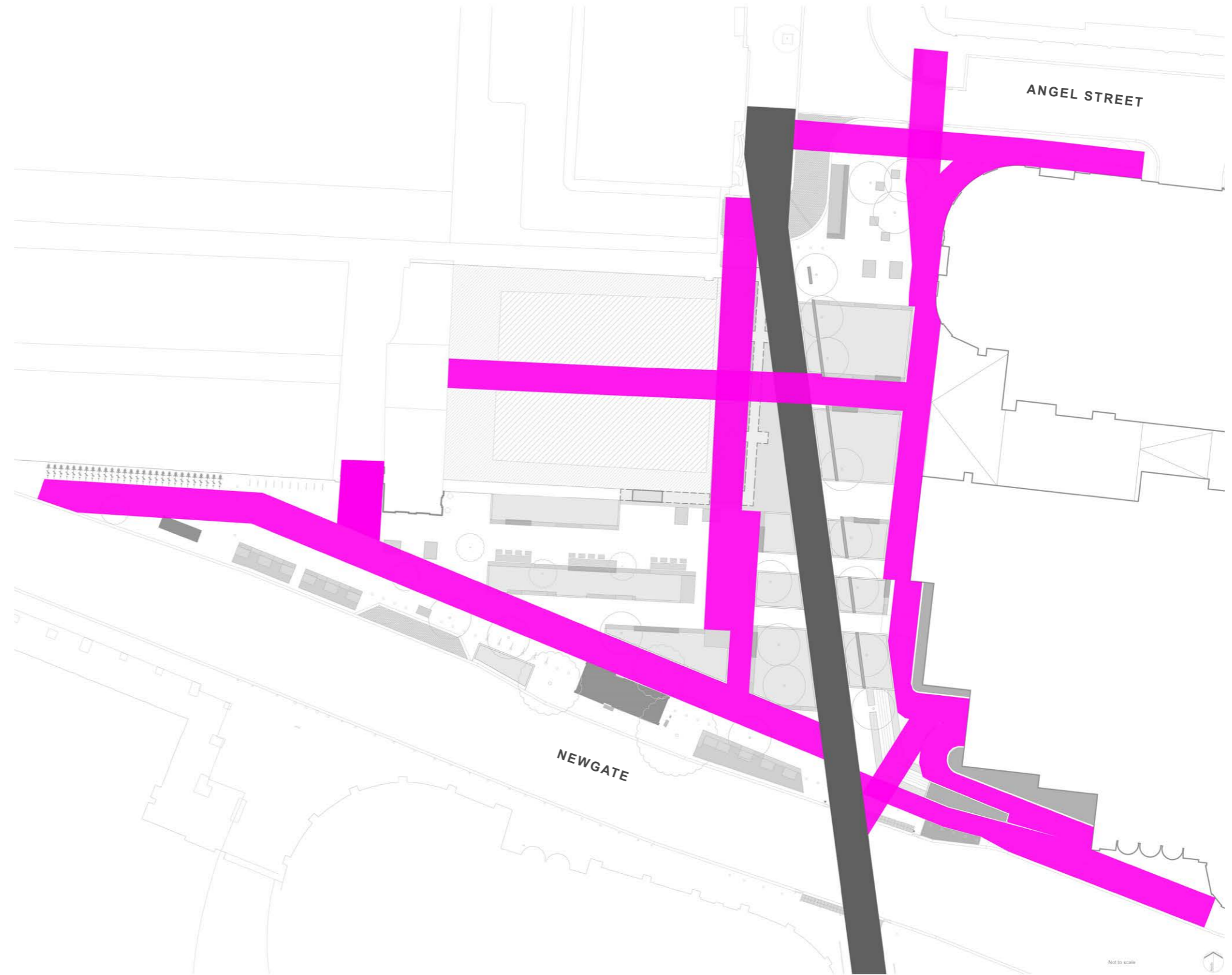

**AREAS OF EXCLUSION FOR PLAY AND/OR
FITNESS EQUIPMENT**

Further movement and structure

Further movement routes provide additional choice and essential structure. The overall grid configuration (defining planting areas) has been carefully developed to blend several opposing geometries to form a singular cohesive place. These should be protected, objects within this structure should be avoided.

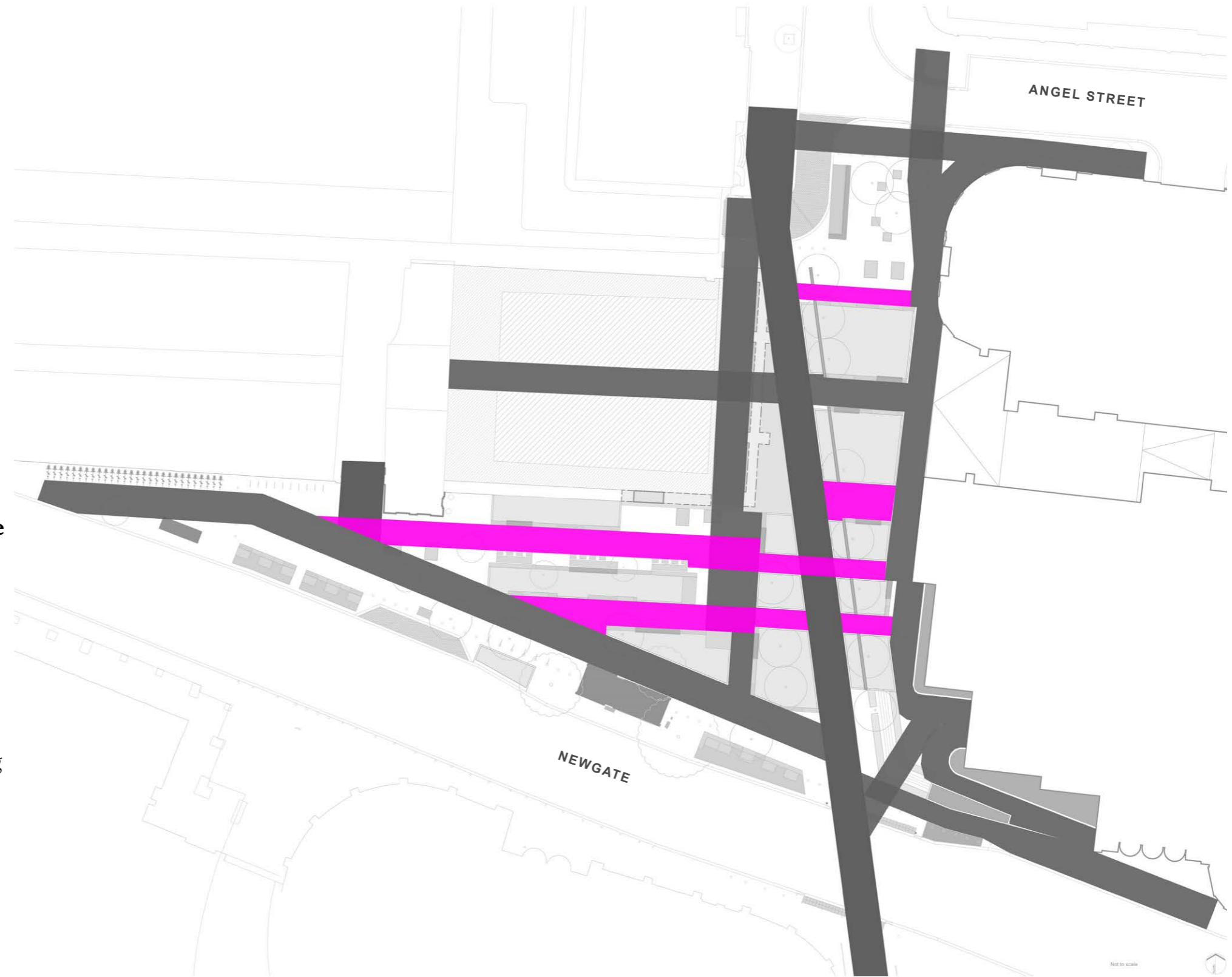

AREAS OF EXCLUSION FOR PLAY AND/OR
FITNESS EQUIPMENT

Building entrances

Access to 81 Newgate from
Greyfriars Square to remain clear

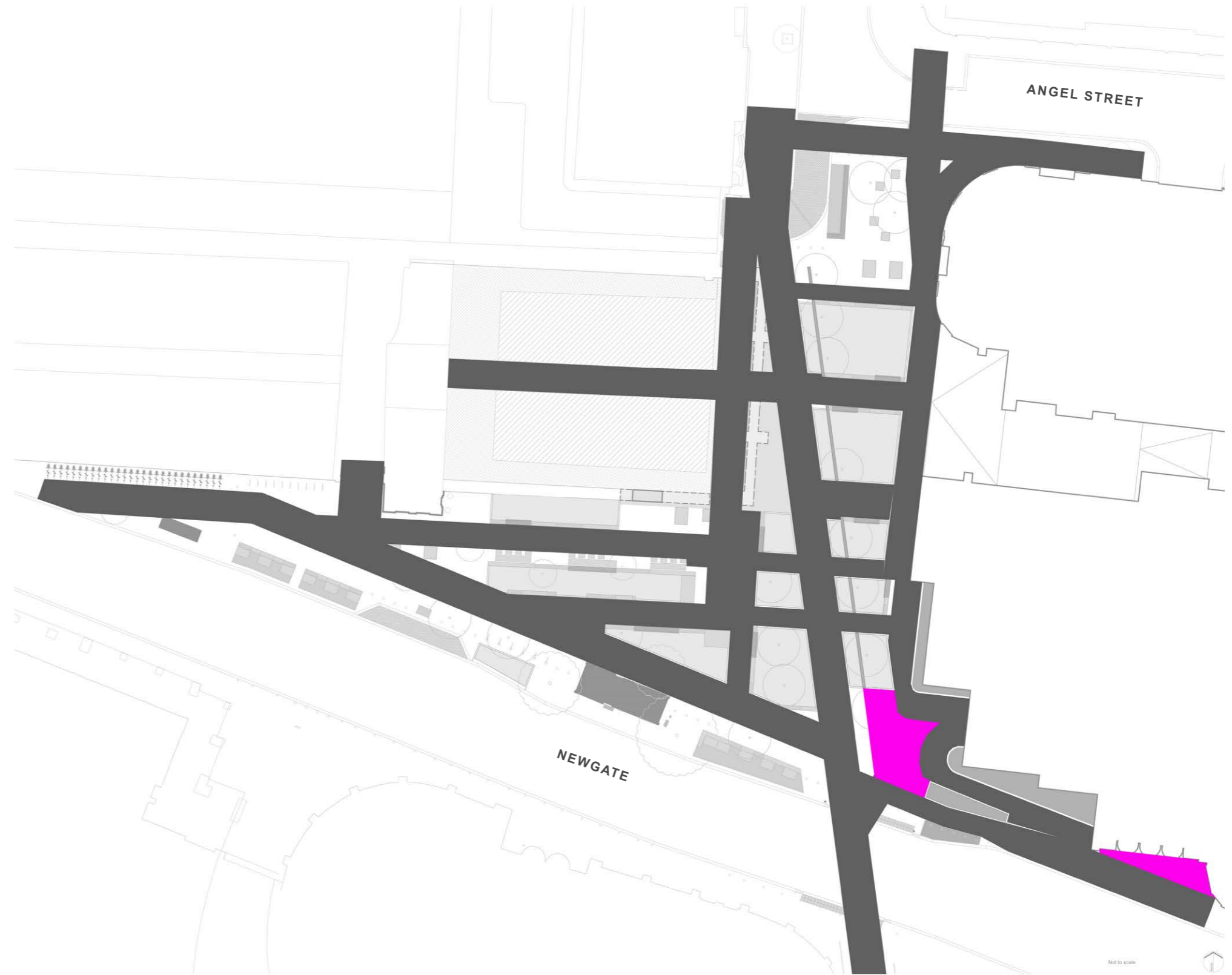

AREAS OF EXCLUSION FOR PLAY AND/OR
FITNESS EQUIPMENT

Key Views

There are two key views that must be left uninterrupted.

1. The view to St. Paul's Cathedral which aligns through Cannon Alley to the North Transept. and,
2. A view from the Internal Street of 81 Newgate to the Spire of Greyfriars Church ruin.

These views are to remain uncluttered with minimal vertical elements that detract from views to those special features.

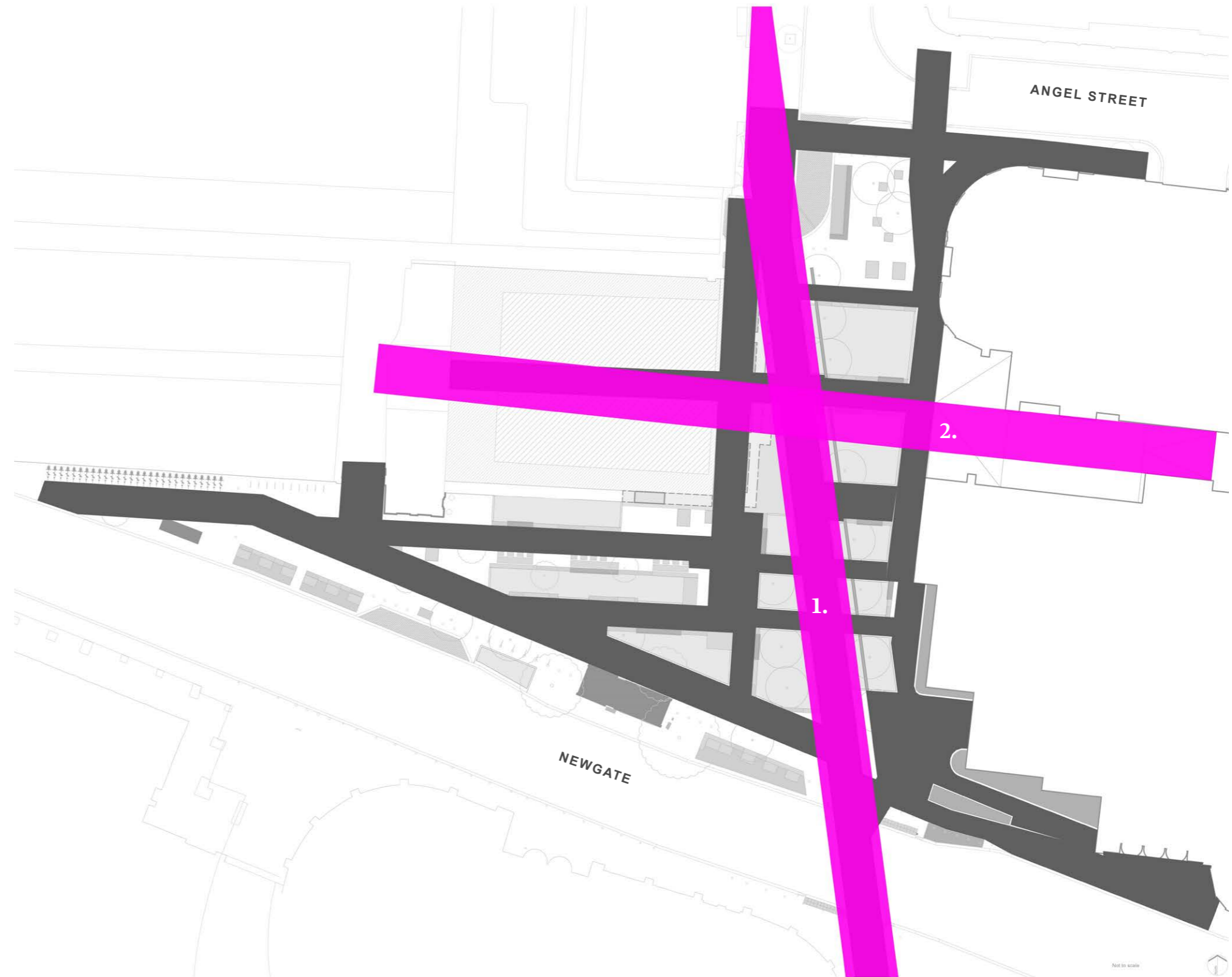

**AREAS OF EXCLUSION FOR PLAY AND/OR
FITNESS EQUIPMENT**

Listed structure & SAM

Whereas the Church ruin is Grade I listed. The site is also a scheduled ancient monument. The tower and ruins of the church stand on the site of the Greyfriars friary church, one of the largest and richest religious establishments of the medieval City with royal patrimony. Objects that may diminish the setting or character of the feature should not be placed within it and may need to be sufficiently set away.

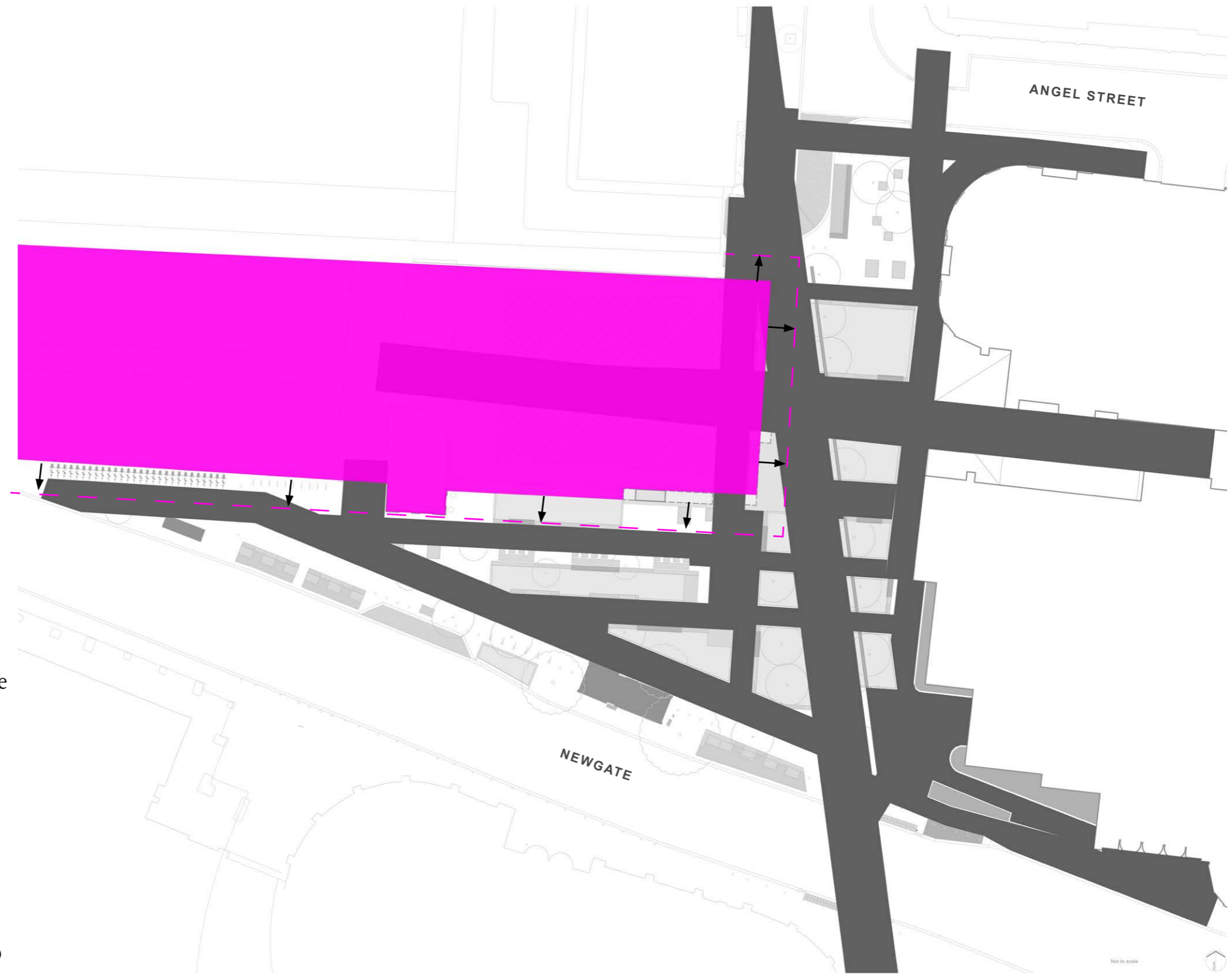

**AREAS OF EXCLUSION FOR PLAY AND/OR
FITNESS EQUIPMENT**

Set back from Newgate

Noise and pollution, access/
informal pedestrian crossing
and likely HVM requirements
removes play potential within space
immediately related to Newgate.



**AREAS OF EXCLUSION FOR PLAY AND/OR
FITNESS EQUIPMENT**

Access road

vehicular access is required to the Bank of America in the north of the site. This part of the proposal also requires a complex HVM component. This space will also provide removable/collapsible/sliding (TBC) bollard access for maintaining and servicing the space.

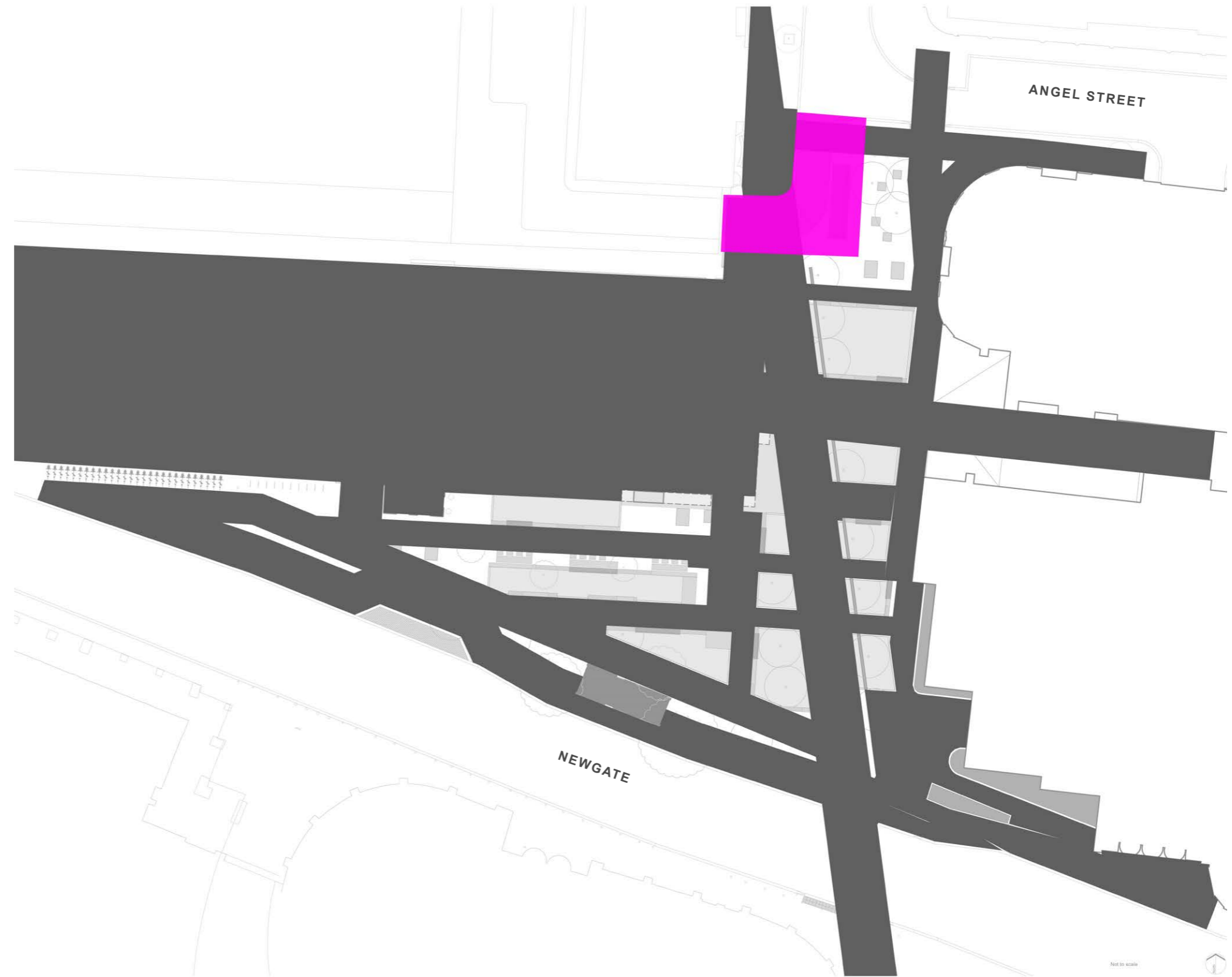

AREAS OF EXCLUSION FOR PLAY AND/OR
FITNESS EQUIPMENT

**The Alee Bridge Walk and
Garden Grid**

Critical to the concept is the 'Garden Grid' (a series of beautiful planted spaces) which flanks and defines the Axial Route to St Pauls. Within this context we have developed the concept for the Alee Bridge Walk, an elegant, linear play feature using special reclaimed granite blocks as stepping stones. Additional alternative proprietary features here for play and/or fitness will weaken these carefully organised ingredients, diluting the defined qualities and experience.



**AREAS OF EXCLUSION FOR PLAY AND/OR
FITNESS EQUIPMENT**

Footprint of Greyfriars Wall

The proposal seeks to provide in-ground interpretation, inlaid art or graphics to the paving surface to reveal the extent of the ruined Wren Church boundary wall. Consideration should be given not only to the defined footprint but also surrounding space for users to view.



AREAS OF EXCLUSION FOR PLAY AND/OR
FITNESS EQUIPMENT

Small spaces removed







Following the preceding process, we remove small spaces incapable of providing adequate safety and fall zones.



AREAS OF EXCLUSION FOR PLAY AND/OR FITNESS EQUIPMENT

Remaining space

Following the clearly defined exclusion exercise we are left with the remaining space to accommodate proprietary play and/or fitness equipment.

- A 
- B 
- C 
- D 
- E 
- F 



Area A:

Considered inappropriate by virtue of proximity to Scheduled Ancient Monument and will likely diminish the setting or character of the special feature.

Furthermore, this narrow space has been previously defined as accommodating docked and dockless cycle space and cycle stands.

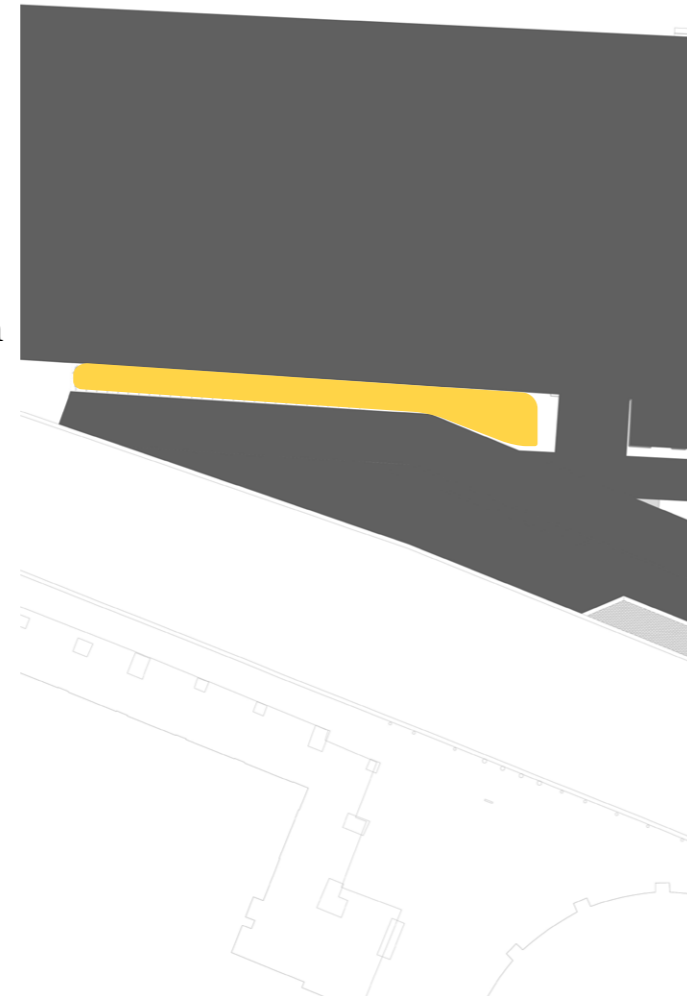

Area B:

Considered inappropriate by virtue of proximity to Scheduled Ancient Monument and will likely diminish the setting or character of the special feature.

The current design provides a simple elegant planting and seating arrangement to flank the Church ruin and a flexible space to accommodate small events, markets, installations etc.

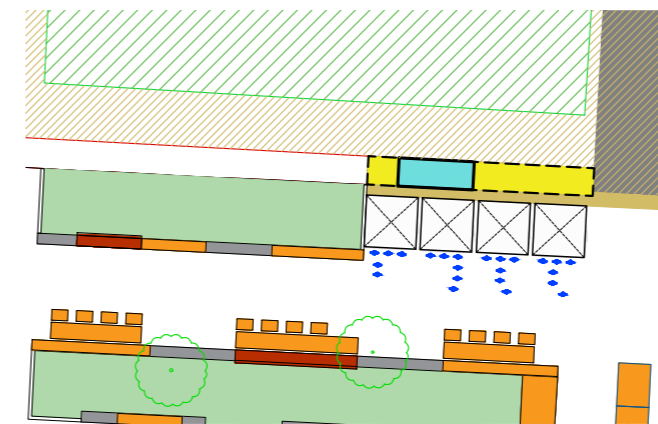
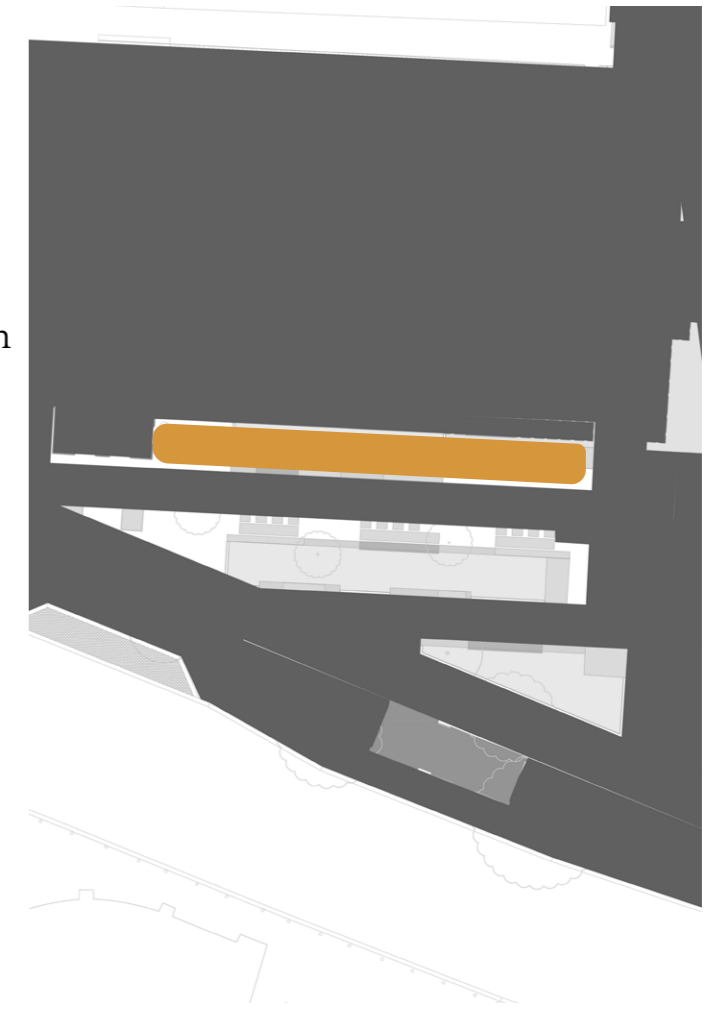

Small craft market cluster test

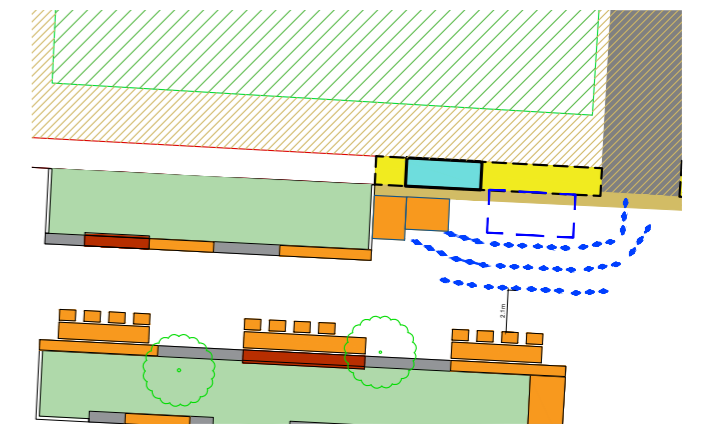

Small performance space test (50 people)

Area C:

Space currently occupied by the centrepiece of the 'Monastic Gardens' character area. The identity is characterised through the concept as having a slower pace with a tighter grain, a varied social condition, and providing close contact with nature. The space accommodates communal dining and working tables and is defined as a calm and peaceful space. Play and fitness equipment here may also diminish the setting or character of the listed structure given it's proximity.

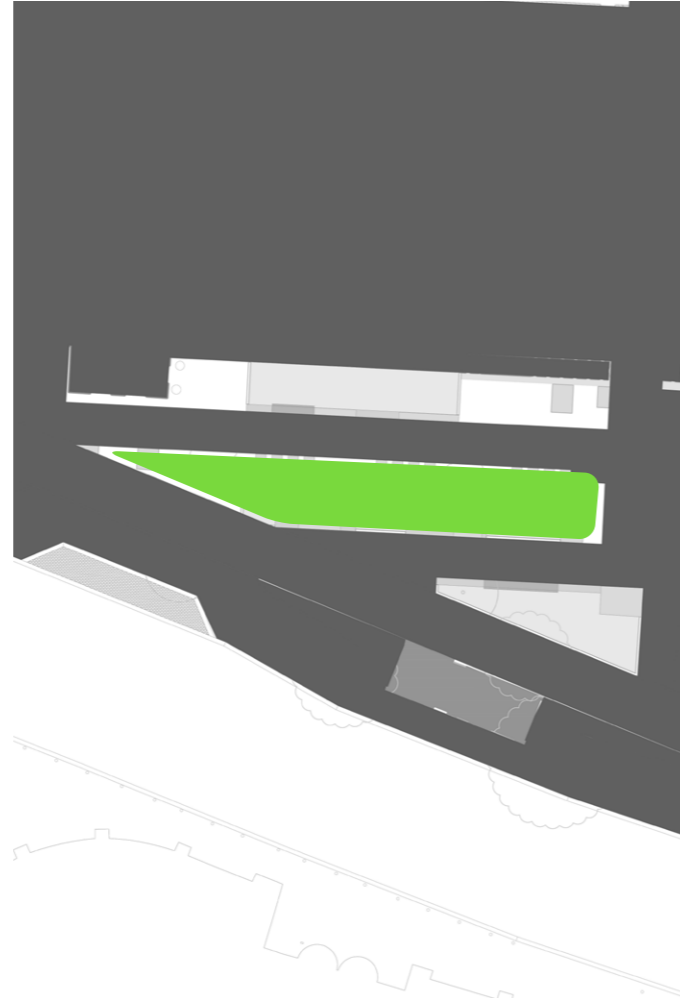

Area D:

This space is relatively small (~9m²). this will result in limited proprietary play and/or fitness equipment potential.

Furthermore it accommodates the very centre of the proposal, defined as the HEART character area. The space is characterised through the concept as being a key orientation space, open and programmable and a place to appreciate the historical narrative of place and links to St. Paul's.

Items placed in this location will become the focus of the scheme and will have an elevated profile by virtue of positioning.

The space currently arranged to provide unimpeded views in all directions and to allow ultimate flexibility to maximise program potential.

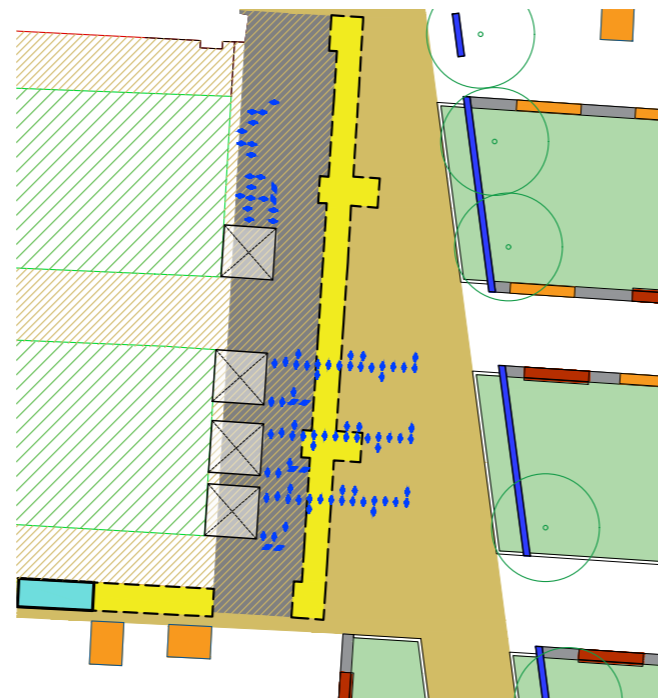

Small street food market test

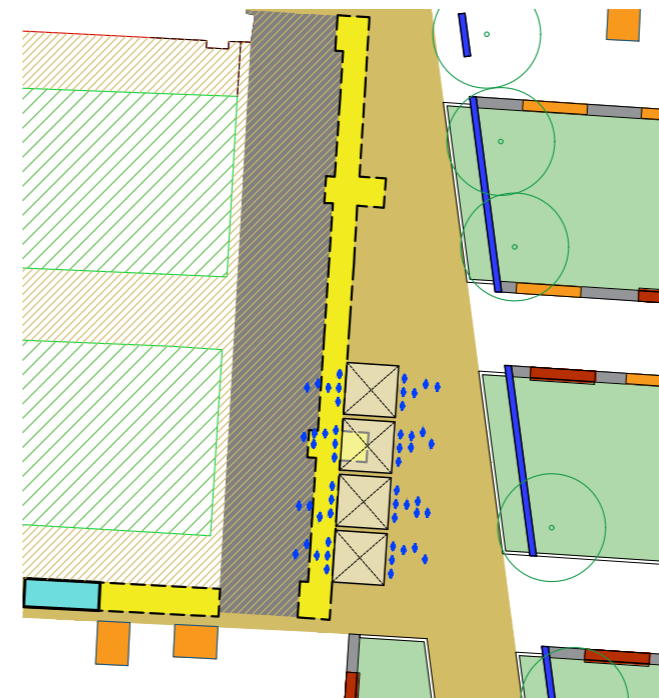

Small craft market cluster test

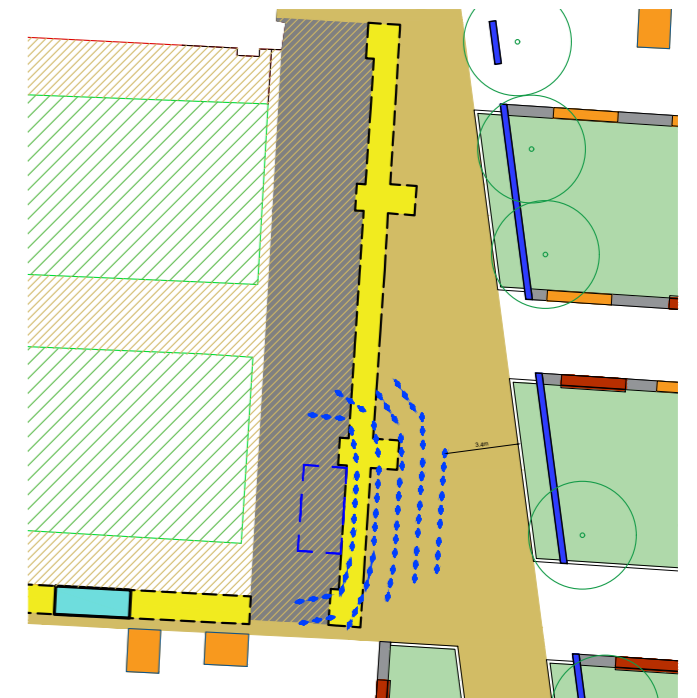

Small performance space test (75 people)

Area E:

This space has limited capacity for static/fixed objects. It is assumed it will experience significant cross movement and general circulation. The approach here is to provide a simple, social welcoming gateway into the wider scheme and provide some flexibility for small scale temporary events. This threshold space will reinforce the character and identity of the place when arriving from the north and relies on its simplicity to draw users into the space and encourage dwell time. From within this space, in legibility terms, users will begin to reference the basic geometry of the scheme, identify the Alee Bridge Walk and views to the remarkable assets of Greyfriars Church ruin and St Paul's Cathedral. Proximity of play and/or fitness equipment to 81 Newgate (HSBC) may be problematic. The space is also close to an access road and general vehicular space.

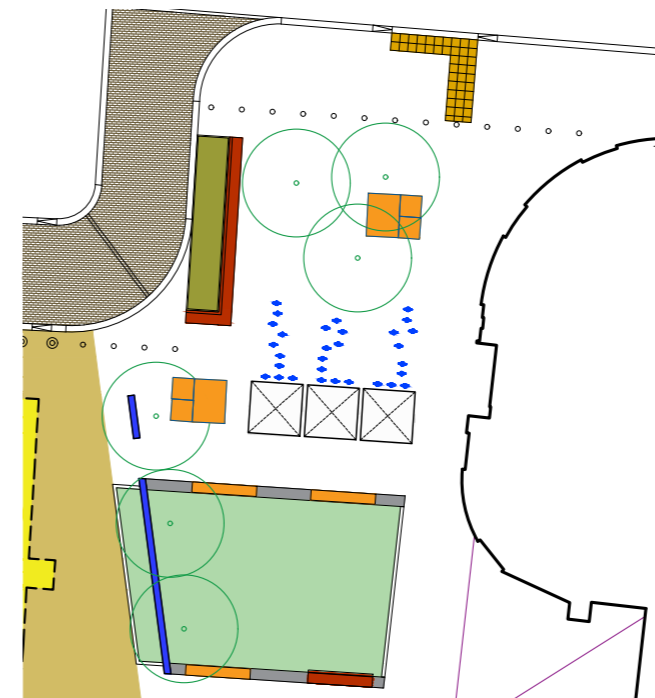

Small street food market test

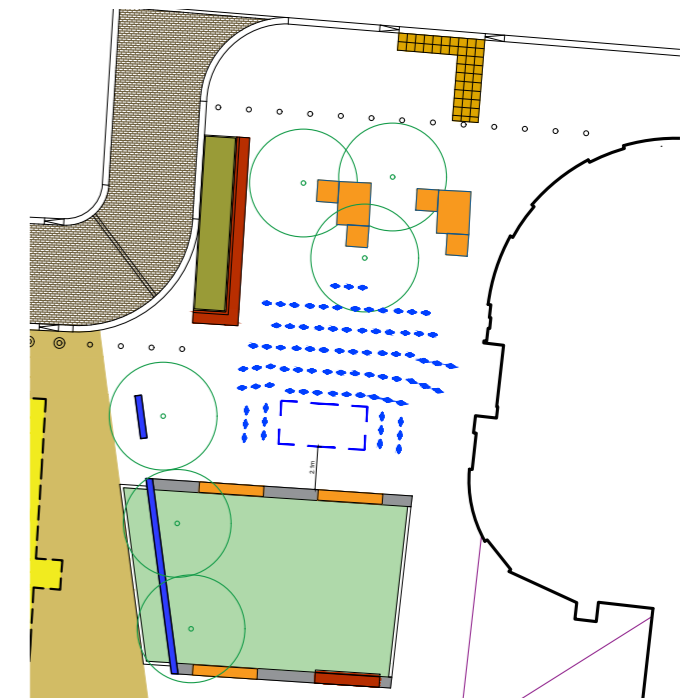

Small performance space test (75 people)

Area F:

This space currently forms part of the 'Monastic Gardens' character area but is more peripheral. It plays an important supportive role to the striated character and structure of the identity, which seeks to provide a tighter grain of calm and reflective garden routes in linear bands.

The space is set back from busy vehicular space, is away from 81 Newgate and Christchurch Tower (Vestry House) and is reasonably detached from the Listed Greyfriars Church ruin. It also benefits from natural protection from the Central Line venting building and does not sit on or parallel with key views to identified assets.

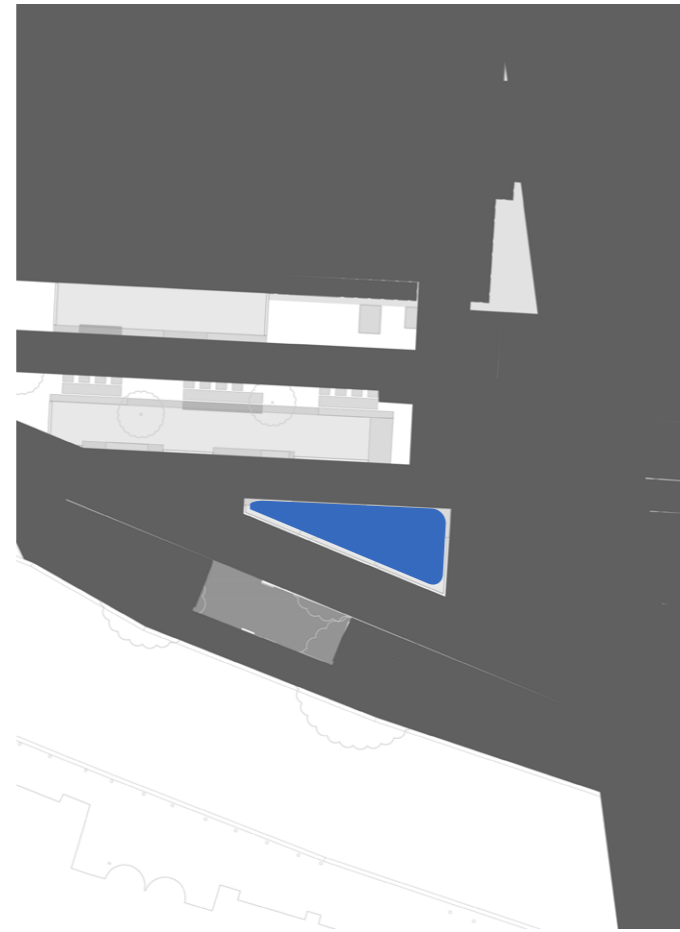

Summary

The landscape design team advise that the focus for play remains on the Alee Bridge Walk and that this should be developed further maximising and fortifying the playable nature of the feature. Exploring variations in vertical and horizontal spacing and travel, gaps between units and sizes of units.

Should the City require additional play and/or fitness beyond the Alee Bridge Walk, we recommend developing **Area F** as the next most appropriate location. The following slides illustrate the typical space required for a selection of proprietary formalised play and sport/fitness equipment and the impact this is likely to have.

Z:\8847_KING_EDWARD_SQUARE\TCAD\DRAWINGS\8847_WORKING BASE_STAGE 3

Current baseline working drawing:

- 620m2 of new planting area
- 420m2 of retained planting (Greyfriars)
- 160 linm of seating
- 45 linm of play feature

Note, these values are variables and currently in flux being impacted on by factors such as:
HVM, building access, furniture and play etc.



- Planting - Rain garden
- Planting - HVM high edges_Hidden bollards
- Paving_01
- Paving_02
- Modern raised wall to Greyfriars Garden_REDUCED to finished floor level - Decorative interpretation of former wall within paving / ground plane
- Proposed Tree
- Existing Tree
- Relocated statue
- Communal dining tables and cube seats (root fixed)
- Timber top
- Timber top with back rest
- Seating pad 2m x 3m (fixed)
- Movable seating pad 1.5m x 2m
- Movable cube seat
- Stone / Concrete edge 500mm x 500mm
- Incidental play element (within planting) Reused granite - Victoria Embankment
- Santander cycles / docking stations / Terminal
- Cycle stands
- HVM PAS 68 rated Cycle Stands
- HVM PAS 68 rated bollards
- Indicative lighting DW Windsor_ 'Sky' lighting column To match Panorama St Paul's Building

REV. DESCRIPTION APP. DATE

LD A DESIGN

PROJECT TITLE
KING EDWARD SQUARE

DRAWING TITLE
General Arrangement Plan

ISSUED BY	Exeter	T: 01392 260 430
DATE	25.04.23	DRAWN MB
SCALE@A1	1:200	CHECKED TS
STATUS	Draft	APPROVED TS

DWG. NO 8847_101

No dimensions are to be scaled from this drawing.
 All dimensions are to be checked on site.
 Area measurements for indicative purposes only.

© LDA Design Consulting Ltd. Quality Assured to BS EN ISO 9001 : 2015
 Sources Ordnance Survey

Scenario 1 – Proprietary play equipment (basic play)

Example equipment shown. This proprietary equipment has been included to indicate the space required and type of equipment applicable for a space of this nature only.

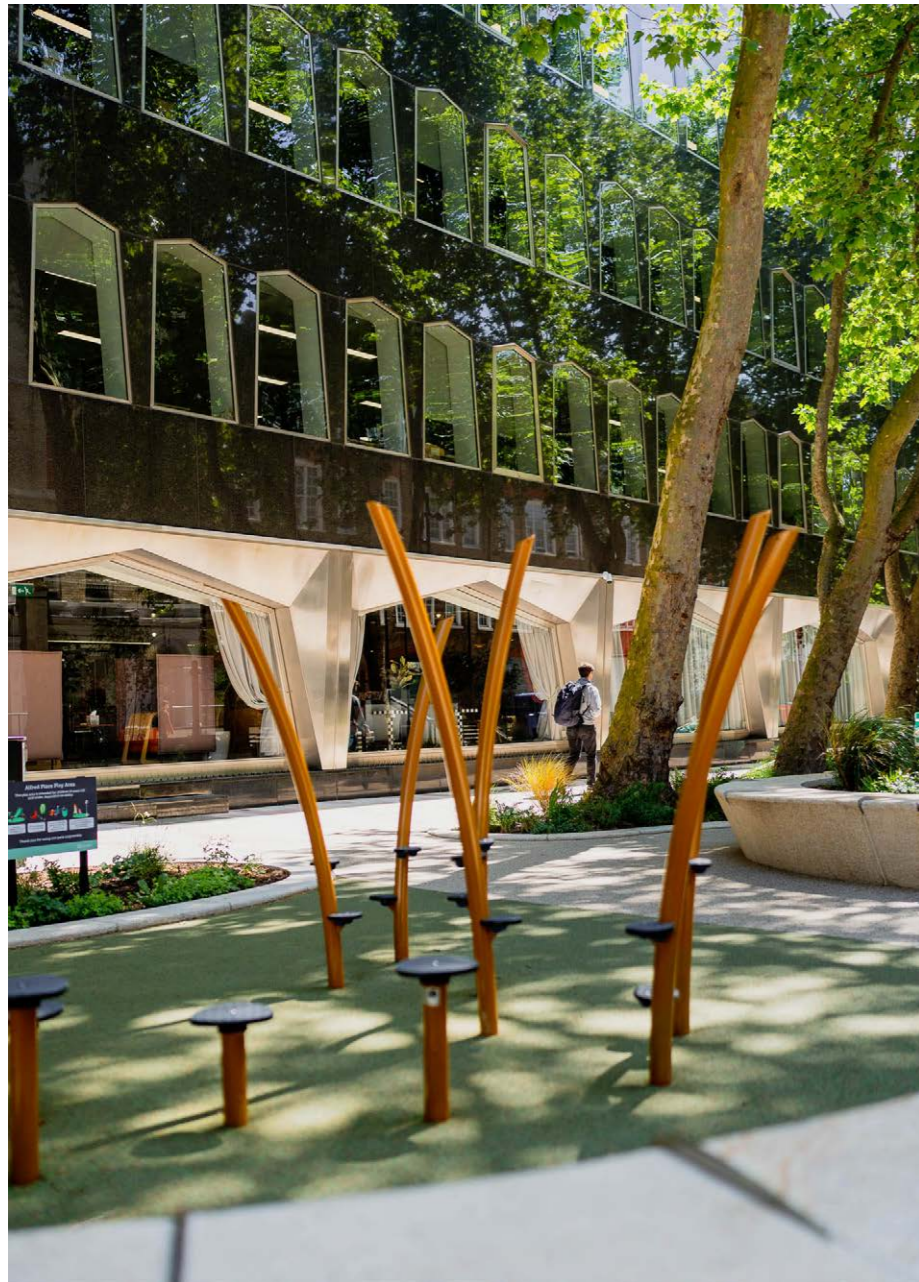

Scenario 1 – Proprietary play equipment (basic play)

- Loss of ~55m² of planting
- Loss of ~16 linM of seating

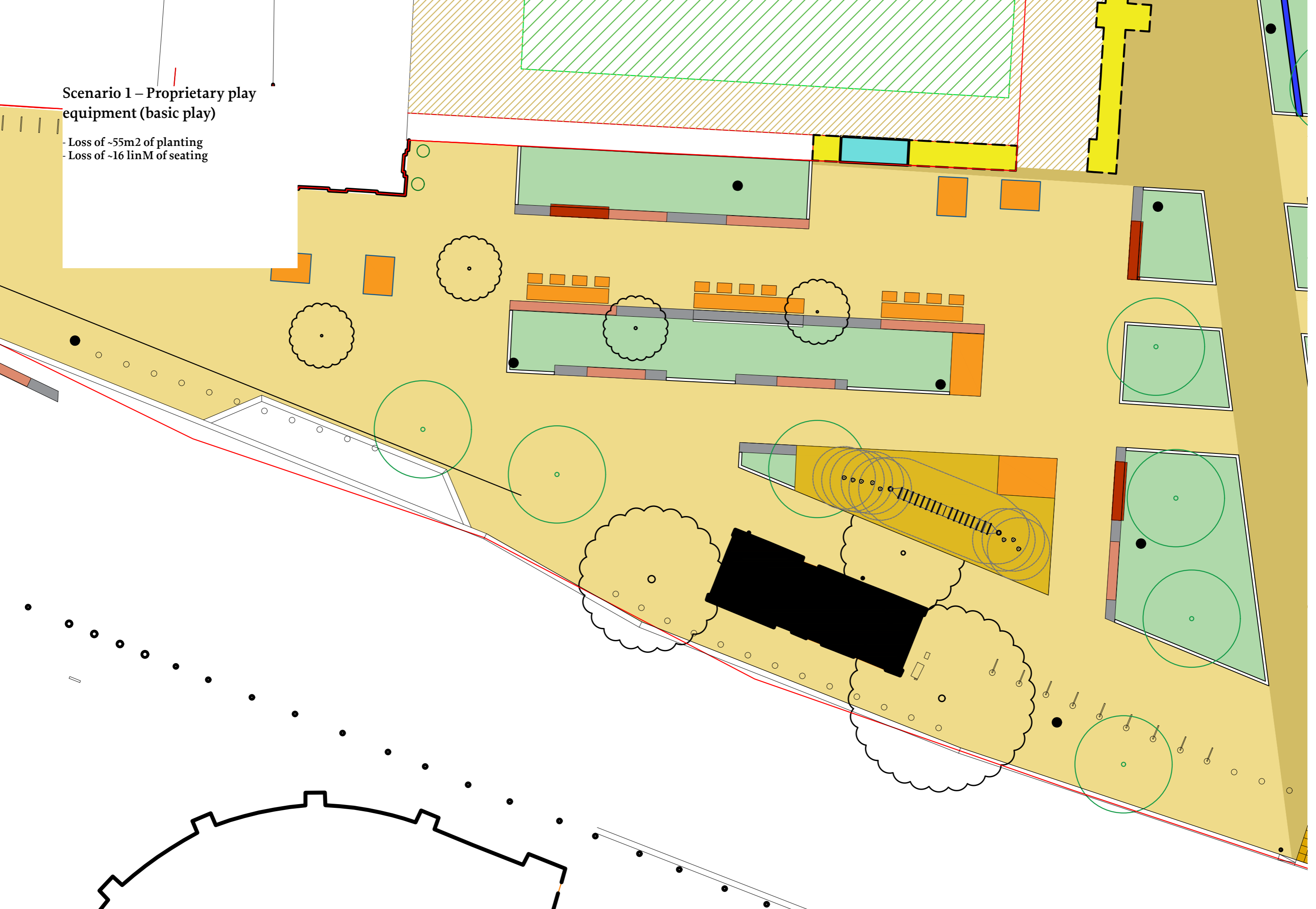

Scenario 2 – Proprietary play equipment (increased playability)

Example equipment shown. This proprietary equipment has been included to indicate the space required and type of equipment applicable for a space of this nature only.

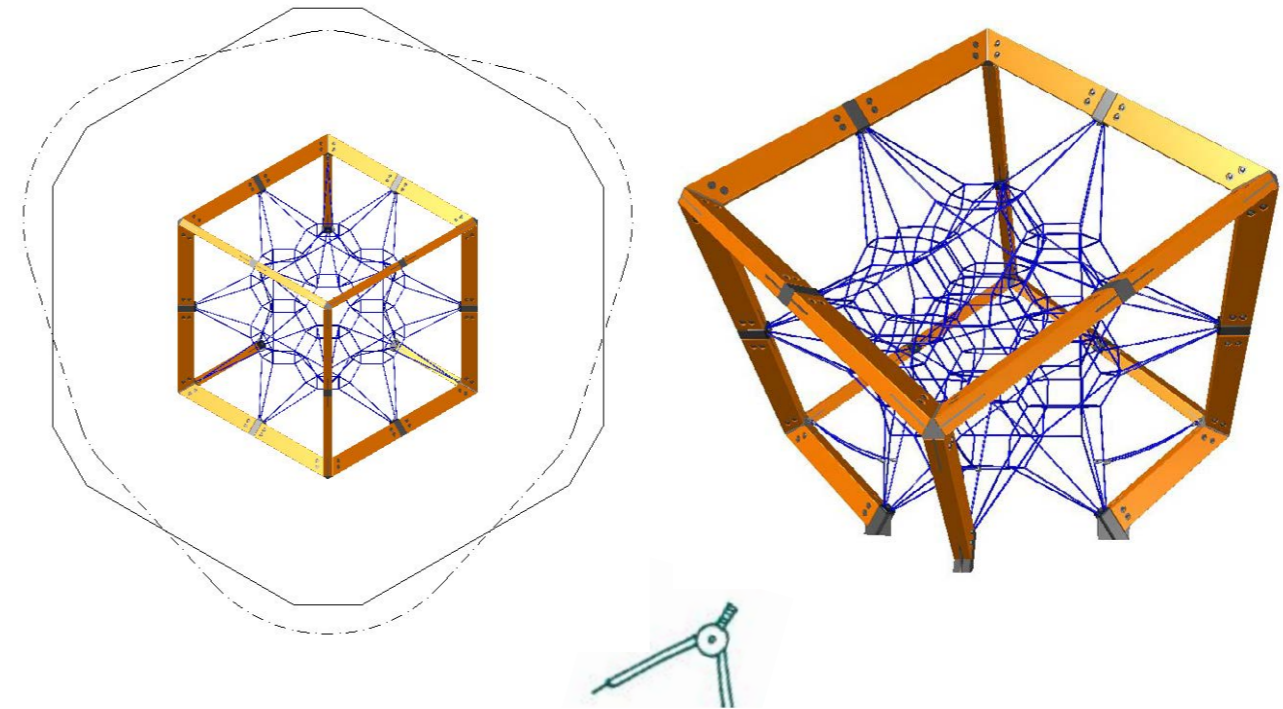

Eddie.01
The Eddie.01 stands up straight for small and big kids who love to go for a spin. With a body and a stem made out of stainless steel, it is weatherproof and looks stylish. The HD PE-platform, with its second colour inlays plus the matching top ball make it look cool. Fun, style and coolness, all rolled into one Playpoint!

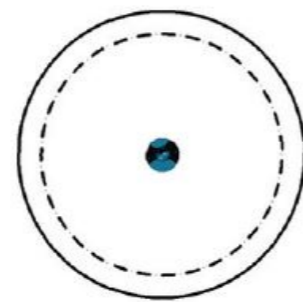

Scenario 2 – increased playability

Formal proprietary play equipment:

- Loss of ~66m² of planting.
- Loss of ~20 linM of seating
- Loss of 50m² of footway and general permeability

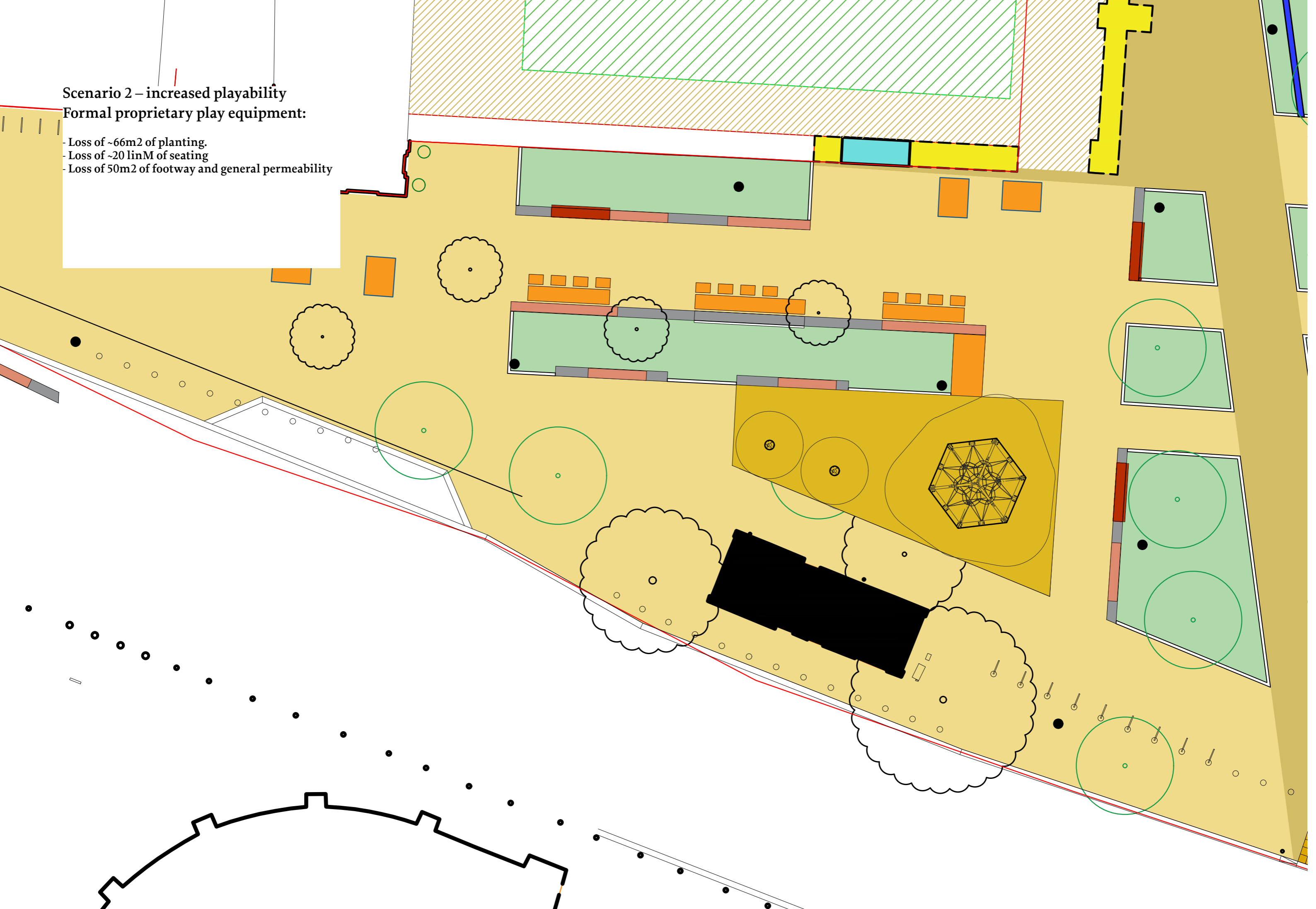

Scenario 3 – Proprietary kinetic fitness equipment:

Example equipment

Leg Press Pro

FAZ603



With adjustable load, adjustable seat, and large footplate, the machine facilitates individually adapted exercises that strengthen hip extensor, knee extensor and ankle muscles in a horizontal forward movement. The strength machines and benches allow for simple, safe, and effective strength training for all major muscle groups. This increases daily functional

capacity, especially for the elderly, sports performance, aesthetic appearance, and metabolic fitness. The 130kg weight stack is fully covered and can be adjusted in steps of 10kg by a smart and patented handle. Making the product very easy to train on and completely safe to be in the outdoors!

Shoulder Press Pro

FAZ604



With adjustable load and multi-functional handles, the machine facilitates individually adapted exercises that strengthen shoulder and elbow extensor muscles in an upward movement. The strength machines and benches allow for simple, safe, and effective strength training for all major muscle groups. This increases daily functional capacity,

especially for the elderly, sports performance, aesthetic appearance, and metabolic fitness. The 80kg weight stack is fully covered and can be adjusted in 16 steps of 5 kg by a smart and patented handle. Making the product very easy to train on and completely safe to be in the outdoors!

City Bike Pro

FAZ50100



The City Bike is an adjustable and interactive piece of cardio equipment which is the same quality and as equally effective as what you expect in equipment at an indoor fitness centre. The City bike is all about comfort; the entry is extremely low and the frame provides an upright riding style, the height of the city bike saddle can be adjusted and the seat is wide.

The patented, self-powered resistance units create a real road cycle experience. The resistance can adapt automatically depending on the pedalling speed, or the users can choose to manually change the resistance on the KOMPAN App.

Scenario 3 – Proprietary kinetic fitness equipment:

Loss of ~50m² of planting.
Loss of ~20 linM of seating

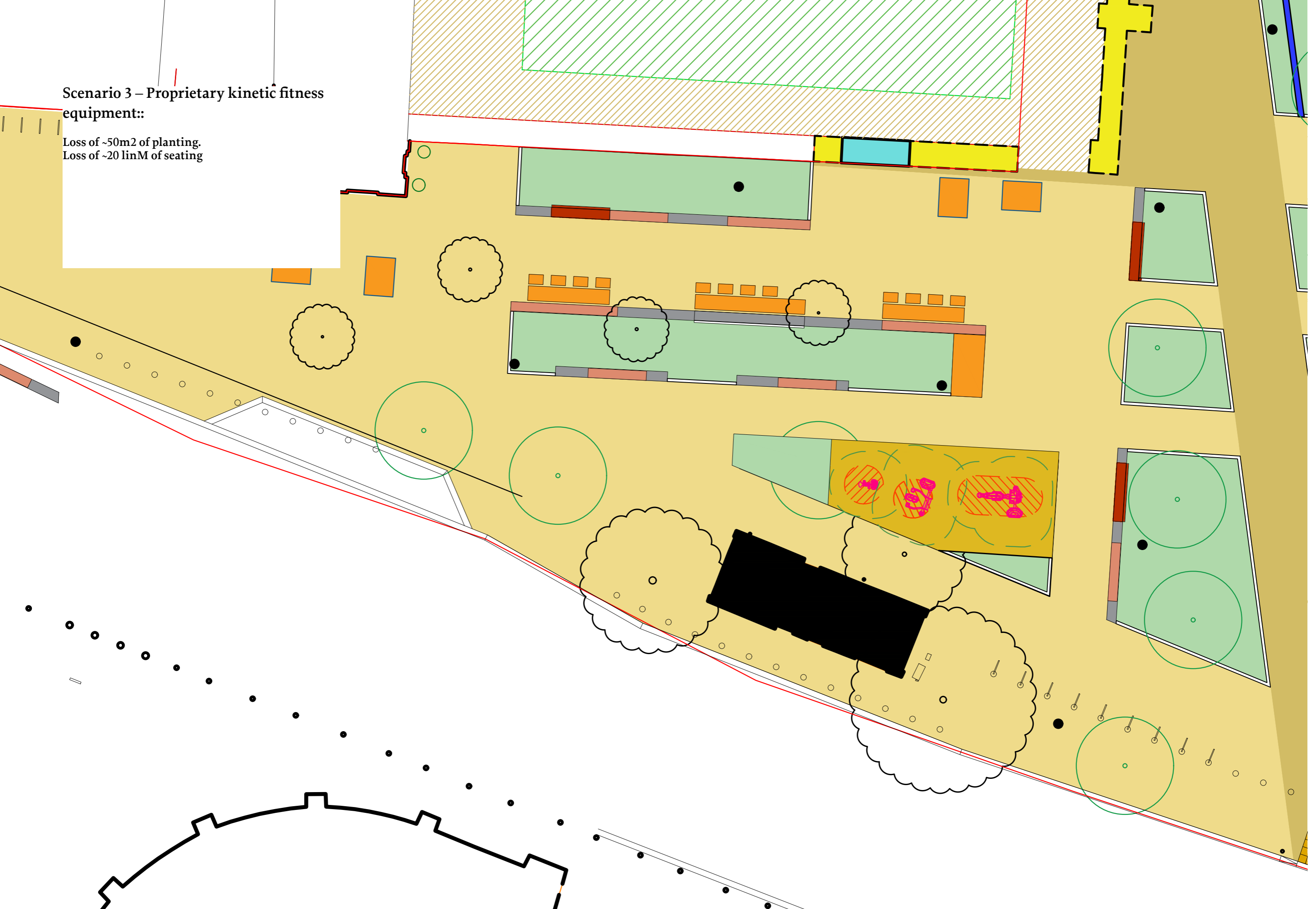

Scenario 4 – Callisthenics station:

Example equipment

Calisthenics.02 – Product Specification



Calisthenics.02

Calisthenics.02 combines climbing and calisthenics in one, and looks good into the bargain! Whether pull-ups or hand-over-hand moves, fitness fans will be spoiled for choice when using this piece of apparatus, which is more than 9 m long. Calisthenics.02 is just one of many possible variants; the colour, shape and functionality can be tailored to your specific requirements so as to fit in with your surroundings, whether urban or natural.

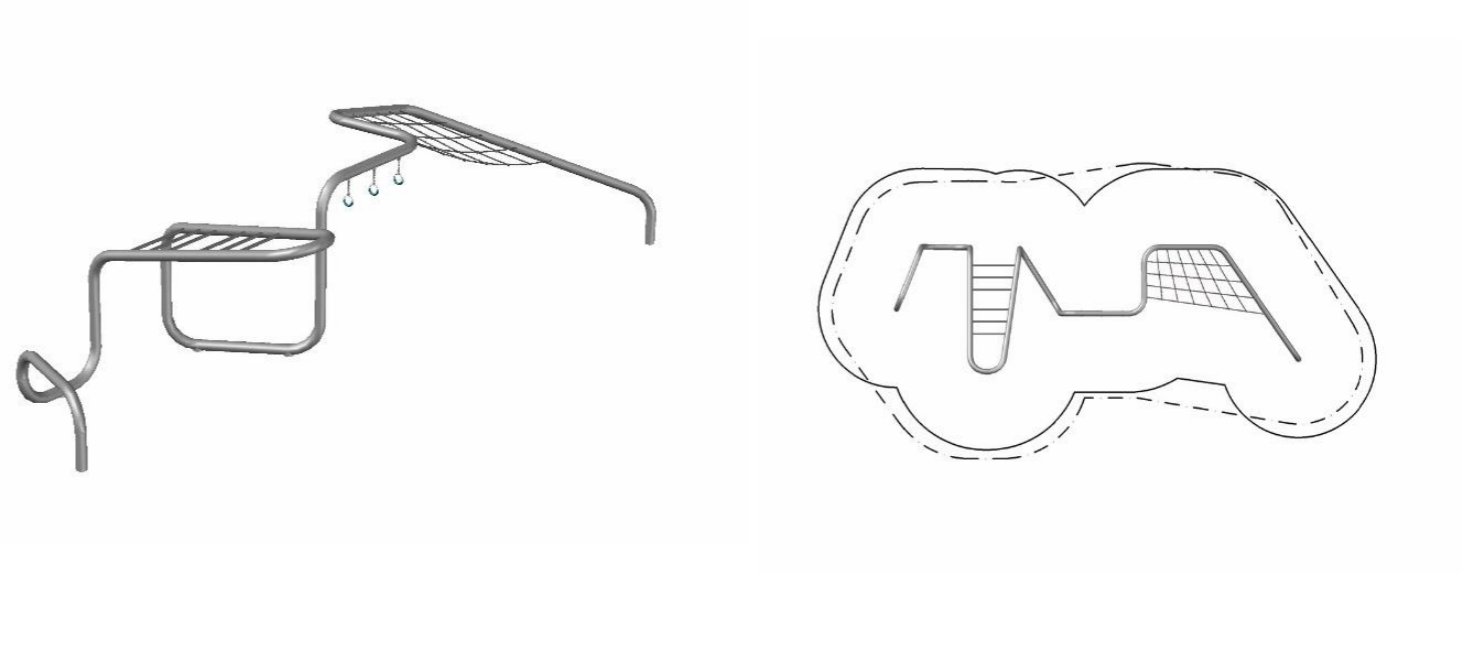

Calisthenics.02 – at a glance.

Product Family:	HodgePodge	Number of Foundations:	Upon request
Item Number:	90.190.481	Concrete Volume C20/C25:	Upon request
Children's Age:	5+	Number of skilled installers required:	Upon request
Fall Height (DIN EN 1176):	2,39 m (7'-10")	Installation Time without foundation:	Upon request
Length x Width x Height:	3,2 m x 9,9 m x 2,4 m	Dimensions of largest part:	Upon request
	(10'-5" x 32'-6" x 7'-10")	Weight of heaviest part:	Upon request
Protective Surfacing Area (DIN EN 1176):	7,2 m x 12,9 m	Transportvolumen:	Upon request
Protective Surfacing Area (ASTM 1487):	6,9 m x 13,6 m	Shipping Volume:	Upon request
	(22'-5" x 44'-6")	Spare part guarantee:	Lifelong
Minimum space required DIN EN 1176:	68,8 m²		
Minimum space required ASTM 1487:	69,8 m² (751 ft²)		

Scenario 4 – Callisthenics station:

- Loss of ~60m² of planting.
- Loss of ~24 linM of seating
- Loss of 45m² of footway and general permeability

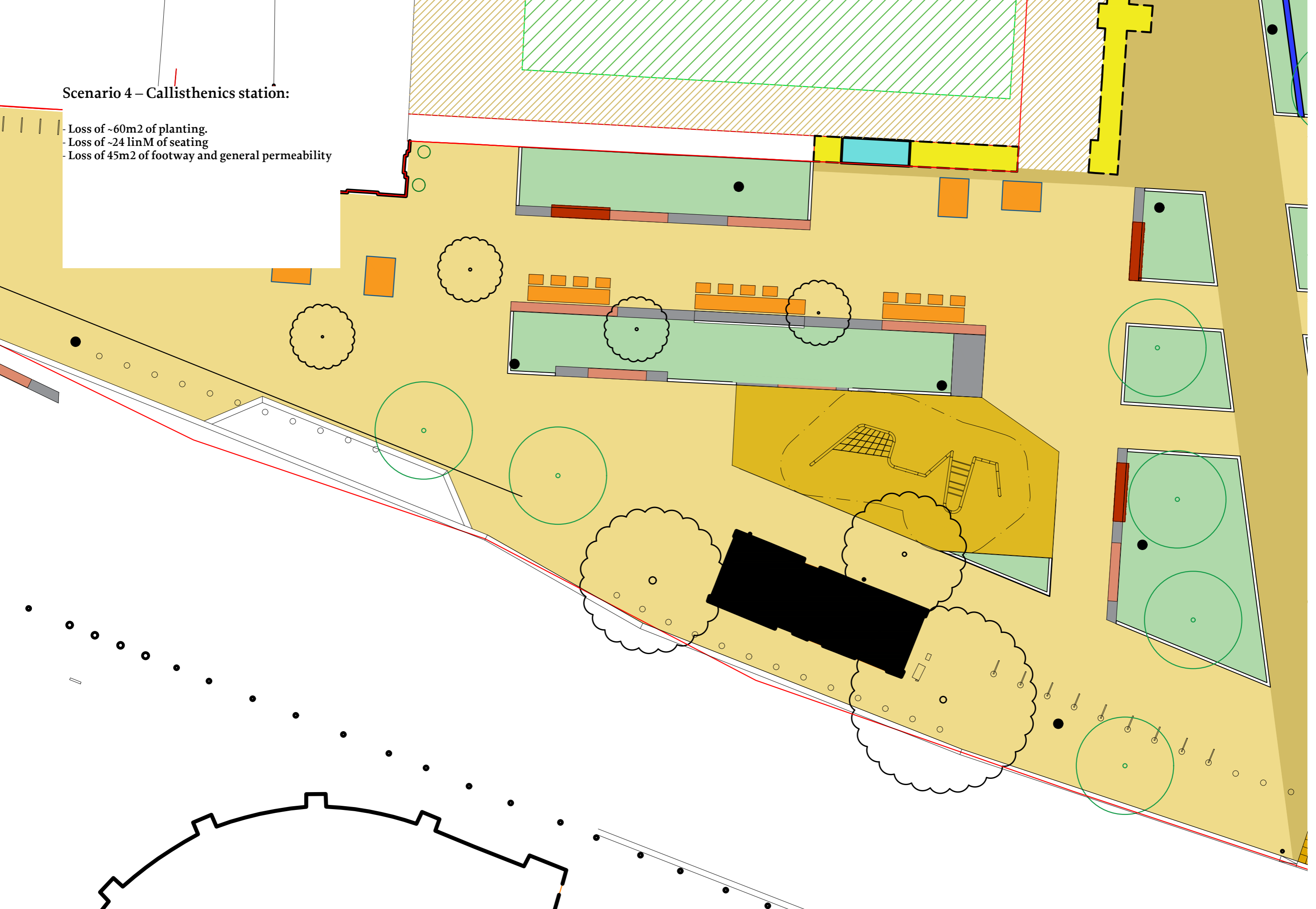

Alternative solution

Should the City require additional play and/or fitness beyond the Alee Bridge Walk, we would suggest considering further informal interventions that can work with a hardy planting infrastructure component.

